

| ITEM NO. | Description                   |
|----------|-------------------------------|
| 1        | Style I-A: Externally lighted |
| 2        | Style I-B: Internally lighted |
| 3        | Style II: Unlighted           |
| 4        | Windsock Frame                |
| 5        | Windsock                      |
| 6        | Mast Assembly                 |
| 7        | Mast Support                  |
| 8        | Foundation Tube               |
| 9        | Junctionbox + PowerSwitch     |
| 10       | L810 Obstruction              |

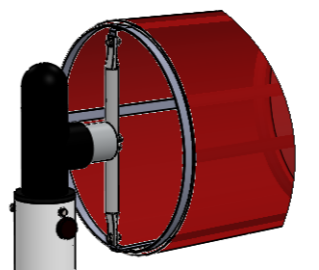

DETAIL C  
SCALE 1 : 15

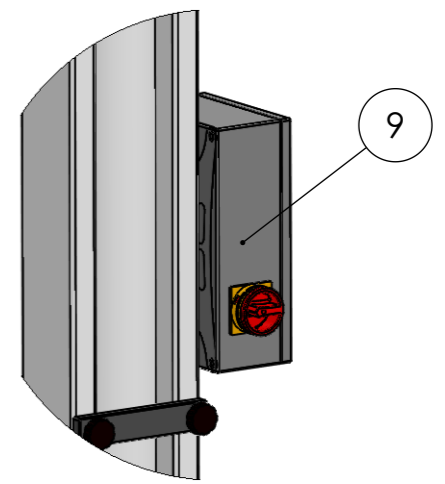

DETAIL D  
SCALE 1 : 10

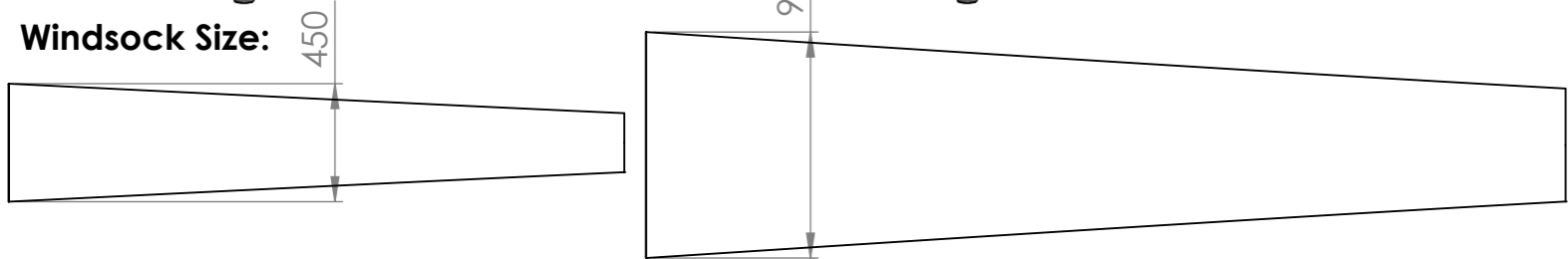

Windsock Size: 450  
Size 1: Ø0.45 m x 2.50 m (Ø18" x 8 feet) Size 2: Ø0.9 m x 3.75 m (Ø36" x 12 feet)

ICAO L-807  
Rigid Supporting Structure  
STYLE I-A

ICAO L-807  
Rigid Supporting Structure  
STYLE I-B

ICAO L-807  
Rigid Supporting Structure  
STYLE II

|   |   |                            |  |
|---|---|----------------------------|--|
| Part name<br>HA_L807  | Description<br>Configurations                         | Material<br>Assembly       | Weight (grams)<br>n/a                            |
| <p>Holland Aviation<br/>Daniëlsweg 40<br/>4451 HW Heinkenszand<br/>T : 0113 - 613467<br/>F : 0113 - 613570</p>  |   | Project<br>060 HA-windsock | Cost<br>See Pricelist                            |
| Projection method:<br>1st angle   | Drawn by: Jermo de Lange<br>Revision date: 28-03-2015 | Units: mm<br>Rev. by: JdL  | Design date: 27-02-2015                          |
| E-mail: <a href="mailto:info@hollandaviation.com">info@hollandaviation.com</a><br><a href="http://www.hollandaviation.com">http://www.hollandaviation.com</a> | Drawing Number<br>807-15B7                            | Item Number<br><b>01</b>   | Rev. Number<br><b>B7</b> Sheet size<br><b>A3</b> |